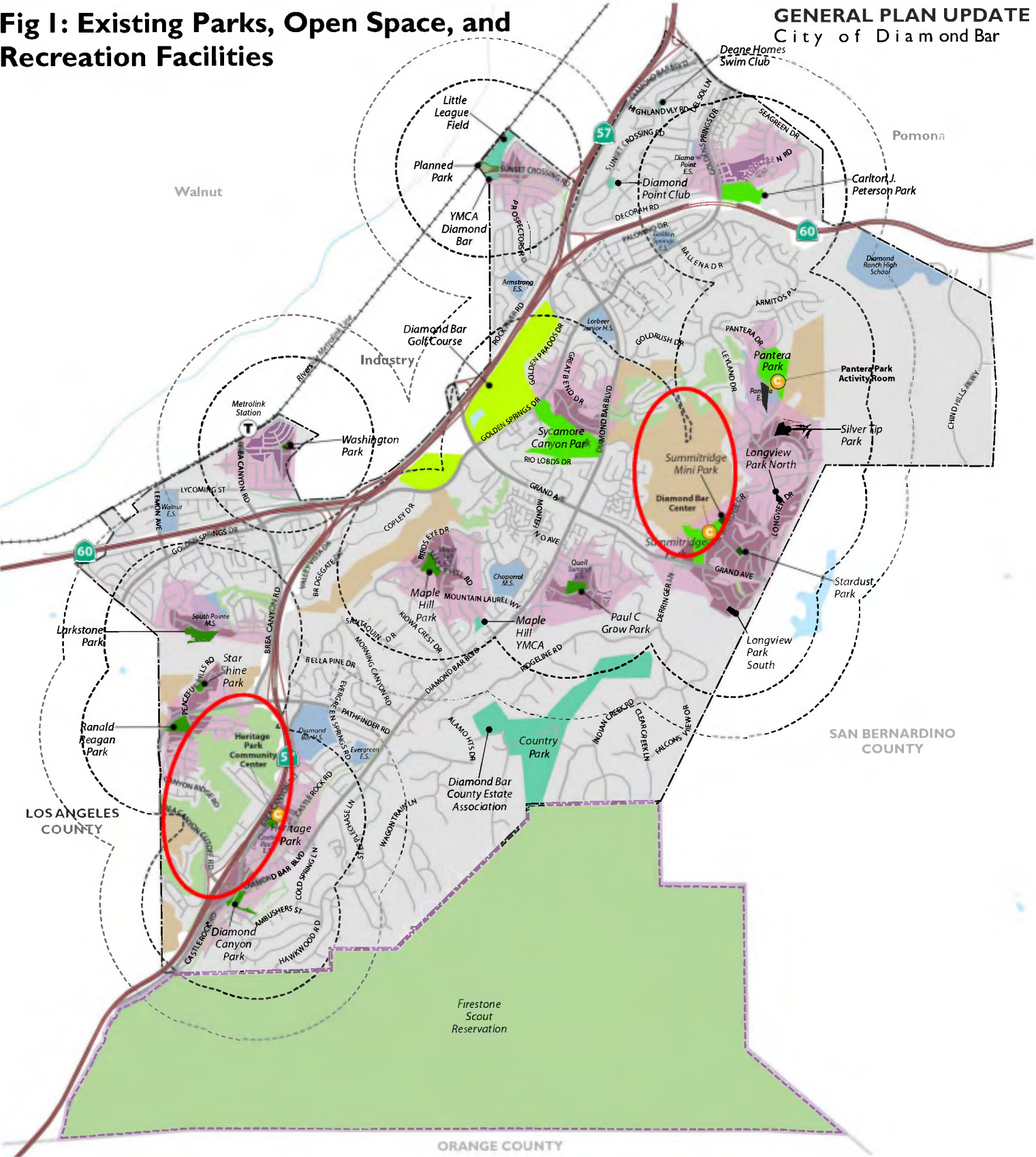

**Fig I: Existing Parks, Open Space, and Recreation Facilities**



	Community Centers	<b>Parks Walkshed*</b>		Vacant Natural Areas		Minor Roads		
	Mini Park		5 Minute Walking Distance		Schools/Educational Facilities		City of Diamond Bar	
	Neighborhood Park		10 Minute Walking Distance		Highways		Sphere of Influence	
	Community Park	<b>Parks Service Area</b>		1/2 Mile Service Radius		Ramps		County Boundary
	Private Park		3/4 Mile Service Radius		Railroads		Major Roads	
	Planned Park							
	Open Space/Greenways/Trails							
	Golf Course							

\*5 Minute and 10 Minute Walksheds are calculated for mini, neighborhood and community parks.

